



THE VALET SPOT™

America's Trusted Leader In
Valet Parking Equipment

Contents

About Us	1
Economical Podiums	2
Specialty Podiums	7
Premium Podiums	10
Custom Podiums	13
Podium Signage	20
Podium Size Chart & Lock Options	22
Sneeze Guards	23
Key Boxes & Boards	24
Delineator Signs	31
Valet Umbrellas	33
Lights	35
Podium Covers	36
Other Equipment	37
Miscellaneous	37
Replacement Parts	40
Portfolio	45
Testimonials	53
Our Values	55
2026 Holiday Service Schedule	56

About Us

The Valet Spot is the industry leader in designing, manufacturing, and shipping specialty parking equipment.

We deliver top-notch, reliable equipment that meets high standards and satisfies customer expectations.

We have a specialized and dedicated customer service team that understands the needs of the parking industry.

We have the world's most comprehensive line of podiums, key boxes, and parking accessories which are backed by a 3-year Manufacturer's Warranty.

Standard Valet Podium

STARTING FROM **\$868**

Economical | Intelligent Design | Fast Shipping



Basic Features

- 50-200 key capacity
- 18 gauge sheet metal
- Scratch-resistant textured black finish
- Key hooks w/ white, screen printed numbers
- Corrosion-resistant hardware (zinc-coated)
- Brushed stainless steel working surface
- Umbrella holder
- 4 Heavy-duty Locking casters
- 2 Metal slam-action locks with 2 keys
- Tip slot
- Replaceable parts
- Pre-assembled
- Manufacturer's Warranty

Dimensions: 24"W x 19"D x 48"H

Weight: 110 lbs.

Interior Upgrades

Door Lock

Combination Lock + \$95.20

Simplex Pushbutton Combination + \$358.40

Schlage Keypad Lock + \$504

Key hooks

100 + \$67.20

150 + \$134.40

200 + \$201.60

Cash Tray Drawer Insert + \$72.80

Heavy Duty Lockable Tip Box + \$67.20

Large Heavy Duty Lockable Tip Box + \$78.40

Short Shelf + \$28.00

Long Shelf + \$56.00

Exterior Upgrades

Transaction Counter + \$61.60

Fold Down Shelf + \$44.80

3 Panel Sneeze guard + \$75.00

Artwork Upgrades

see page 20

Large Magnet + FROM \$205.00

Vinyl Decal + FROM \$275.00

Vinyl Wrap + FROM \$450.00

Accessories

Podium Cover + \$89.60

Heavy Duty Podium Cover + \$128.80

Valet Umbrella + \$285.60

Valet Flap Umbrella + \$336.00

Key Fob Pouch + \$39.20 / pack of 10

Key Fob Pouch - RFID Protection
+ \$28 / pack of 5

White Standard Valet Podium

STARTING FROM **\$868**

Economical | Intelligent Design | Fast Shipping



Basic Features

- 50-200 key capacity
- 18 gauge sheet metal
- Scratch-resistant textured white finish
- Key hooks w/ black, screen printed numbers
- Corrosion resistant hardware (zinc coated)
- Brushed stainless steel working surface
- Umbrella holder
- 4 Heavy-duty Locking casters
- 2 Metal slam-action locks with 2 keys
- Tip slot
- Replaceable parts
- Pre-assembled
- Manufacturer's Warranty

Dimensions: 24"W x 19"D x 48"H

Weight: 110 lbs.

Interior Upgrades

Door Lock

Combination Lock + \$95.20

Simplex Pushbutton Combination + \$358.40

Schlage Keypad Lock + \$504

Key hooks

100 + \$67.20

150 + \$134.40

200 + \$201.60

Cash Tray Drawer Insert + \$72.80

Heavy Duty Lockable Tip Box + \$67.20

Large Heavy Duty Lockable Tip Box + \$78.40

Short Shelf + \$28.00

Long Shelf + \$56.00

Exterior Upgrades

Transaction Counter + \$61.60

Fold Down Shelf + \$44.80

3 Panel Sneeze guard + \$75.00

Artwork Upgrades

see page 20

Large Magnet + FROM \$205.00

Vinyl Decal + FROM \$275.00

Vinyl Wrap + FROM \$450.00

Accessories

Podium Cover + \$89.60

Heavy Duty Podium Cover + \$128.80

Valet Umbrella + \$285.60

Valet Flap Umbrella + \$336.00

Key Fob Pouch + \$39.20 / pack of 10

Key Fob Pouch - RFID Protection
+ \$28 / pack of 5

NEW Light Box Valet Podium

STARTING FROM **\$1092**



Basic Features

- Light box signage with acrylic panel for custom graphics
- 50-200 key capacity
- 18 gauge sheet metal
- Scratch-resistant textured black finish
- Key hooks w/ white, screen printed numbers
- Corrosion-resistant hardware (zinc-coated)
- Brushed stainless steel working surface
- Umbrella holder
- 4 Heavy-duty Locking casters
- 2 Metal slam-action locks with 2 keys
- Tip slot
- Replaceable parts
- Pre-assembled
- Manufacturer's Warranty

Dimensions: 24"W x 19"D x 48"H
Weight: 110 lbs.

Interior Upgrades

Door Lock

- Combination Lock + \$95.20
- Simplex Pushbutton Combination + \$358.40
- Schlage Keypad Lock + \$504

Key hooks

- 100 + \$67.20
- 150 + \$134.40
- 200 + \$201.60
- Cash Tray Drawer Insert + \$72.80
- Heavy Duty Lockable Tip Box + \$67.20
- Large Heavy Duty Lockable Tip Box + \$78.40
- Short Shelf + \$28.00
- Long Shelf + \$56.00

Exterior Upgrades

- Transaction Counter + \$61.60
- Fold Down Shelf + \$44.80
- 3 Panel Sneeze guard + \$75.00

Artwork & Lighting Upgrades

- Vinyl Print + \$200.00
- LED Kit + \$487.20

Accessories

- Podium Cover + \$89.60
- Heavy Duty Podium Cover + \$128.80
- Valet Umbrella + \$285.60
- Valet Flap Umbrella + \$336.00
- Key Fob Pouch + \$39.20 / pack of 10
- Key Fob Pouch - RFID Protection + \$28 / pack of 5

Compact Valet Podium

STARTING FROM **\$840**

Least Expensive LED Podium



Shown above with LED Kit upgrade

Basic Features

- Stylish stainless steel accents
- Easy grab handles for portability
- Folding door and drawer handles
- 2 Heavy-duty Non-locking casters
- 100 key hooks
- 2 Metal cam locks w/ 4 keys
- 18 gauge steel
- Scratch-resistant textured black finish
- Key hooks w/ white, screen printed numbers
- Umbrella Holder
- Brushed stainless steel working surface
- Pre-assembled
- Replaceable Parts
- Manufacturer's Warranty

Dimensions: 18"W x 19"D x 48.5"H

Weight: 98 lbs.

Interior Upgrades

Combination Lock (Door Lock) + \$95.20

Cash Tray Drawer Insert + \$72.80

Heavy Duty Lockable Tip Box + \$67.20

Exterior Upgrades

Trim Colors (Stainless Steel / Black Trim)

Fold Down Shelf + \$44.80

LED Kit (No Battery) + \$140.00

LED Kit + \$448.00

3 Panel Sneeze Guard+ \$75.00

Artwork Upgrades

see page 20

Large Magnet + FROM \$205.00

Vinyl Decal + FROM \$275.00

Accessories

Podium Cover + \$89.60

Heavy Duty Podium Cover + \$128.80

Valet Umbrella + \$285.60

Valet Flap Umbrella + \$336.00

Key Fob Pouch + \$39.20 / pack of 10

Key Fob Pouch - RFID Protection
+ \$28 / pack of 5

Portable Valet Podium

STARTING FROM **\$856.80**

Portable | Full Size | Fast Shipping



Basic Features

- Easy grip handles and 4" casters for transportation
- Durable metal construction
- Scratch-resistant, textured black finish
- Interchangeable black sign (550mm x 830mm, 3mm thick)
- 100 Key hook capacity
- Key cam lock
- Steel working surface with umbrella holder
- 3 pins keep podium locked when folded
- Podium cover (folded)
- Manufacturer's Warranty

Dimensions: 27"W x 21"D x 48"H

Weight: 70 lbs.

Accessories

Valet Umbrella + \$285.60

Valet Flap Umbrella + \$336.00

Key Fob Pouch + \$39.20 / pack of 10

Key Fob Pouch - RFID Protection
+ \$28 / pack of 5



Deluxe Valet Podium

STARTING FROM **\$1428**

Our second largest podium and the preference for low staff high volume accounts



Shown above with Key hooks upgrade

Basic Features

- Counter top with brushed stainless steel trim
- Key drop hole with theft guard
- Electronic compatible
- Tip box installed
- Locking security bar
- Anchor loop
- 16 gauge, heavy duty sheet metal construction
- 50-200 key capacity
- Scratch-resistant textured black finish
- Key hooks w/ white, screen printed numbers
- Zinc hardware
- Brushed stainless steel working surface
- Umbrella holder
- 4 Heavy-duty Locking casters
- 2 Metal Slam-action locks with 2 keys
- Tip slot
- Replaceable parts
- Pre-assembled
- Manufacturer's Warranty

Dimensions: 36.5"W x 24"D x 49"H

Weight: 125 lbs.

Interior Upgrades

Door Lock

Combination Lock + \$95.20

Simplex Pushbutton Combination + \$358.40

Schlage Keypad Lock + \$504

Key hooks

100 + \$67.20

150 + \$134.40

200 + \$201.60

Short Shelf + \$33.60

Long Shelf + \$61.60

Exterior Upgrades

Counter Trim Color (Stainless / Black)

LED Kit (No Battery) + \$179.20

LED Kit + \$487.20

Bottom Trim + \$168.00

Fold Down Shelf + \$44.80

3 Panel Sneeze guard + \$75.00

Artwork Upgrades

see page 20

Large Magnet + FROM \$205.00

Vinyl Decal + FROM \$275.00

Vinyl Wrap + FROM \$450.00

Accessories

Podium Cover + \$89.60

Heavy Duty Podium Cover + \$128.80

Valet Umbrella + \$285.60

Valet Flap Umbrella + \$336.00

Key Fob Pouch + \$39.20 / pack of 10

Key Fob Pouch - RFID Protection
+ \$28 / pack of 5



with LED Kit upgrade



with Bottom Trim upgrade

White Deluxe Valet Podium

STARTING FROM **\$1428**

Upscale Look | Enhanced Security | Electronics Ready



Shown above with Schlage lock upgrade

Basic Features

- Countertop with brushed stainless steel trim
- Key drop hole with theft guard
- Electronic compatible
- Tip box(white finish) installed
- Locking security bar
- Anchor loop
- 16 gauge, heavy-duty sheet metal construction
- 50-200 key capacity
- Scratch-resistant textured white finish
- Key hooks w/ black, screen printed numbers
- Zinc hardware
- Brushed stainless steel working surface
- Umbrella holder
- 4 Heavy-duty Locking casters
- 2 Metal Slam-action locks with 2 keys
- Tip slot
- Replaceable parts
- Pre-assembled
- Manufacturer's Warranty

Dimensions: 36.5"W x 24"D x 49"H

Weight: 125 lbs.

Interior Upgrades

Door Lock

Combination Lock + \$95.20

Schlage Keypad Lock + \$504

Key hooks

100 + \$67.20

150 + \$134.40

200 + \$201.60

Short Shelf + \$33.60

Long Shelf + \$61.60

Exterior Upgrades

LED Kit (No Battery) + \$179.20

LED Kit + \$487.20

3 Panel Sneeze guard + \$75.00

Artwork Upgrades

see page 20

Large Magnet + FROM \$205.00

Vinyl Decal + FROM \$275.00

Vinyl Wrap + FROM \$450.00

Accessories

Podium Cover + \$89.60

Heavy Duty Podium Cover + \$128.80

Valet Umbrella + \$285.60

Valet Flap Umbrella + \$336.00

Key Fob Pouch + \$39.20 / pack of 10

Key Fob Pouch - RFID Protection + \$28 / pack of 5



Heavy Duty Deluxe Podium

STARTING FROM **\$2912**

Secure | Professional | Innovative



Basic Features

- 9 gauge, heavy-duty sheet metal construction (Door)
- 16 gauge, heavy-duty sheet metal construction (Rest of the podium)
- Countertop with brushed stainless steel trim
- Scratch-resistant textured black finish
- Zinc hardware
- Prybar defense plates
- Locking security bar
- Schlage door lock
- 50-200 key capacity
- Key hooks w/ white, screen printed numbers
- Tip slot
- Tip box installed
- Anchor loop
- 2 Locking, 2 non-locking Heavy-duty casters
- Umbrella holder
- Electronic device compatible
- LED Compatible
- Replaceable parts
- Pre-assembled
- Manufacturer's Warranty

Dimensions: 38.5" W x 24.5" D x 50"H **Weight:** 250 lbs

Interior Upgrades

Key hooks

100 + \$67.20

150 + \$134.40

200 + \$201.60

Long Shelf + \$61.60

Exterior Upgrades

LED Kit (No Battery) + \$179.20

LED Kit + \$487.20

3 Panel Sneeze guard + \$89.60

Artwork Upgrades

see page 20

Large Magnet + FROM \$205.00

Vinyl Decal + FROM \$275.00

Vinyl Wrap + FROM \$450.00

Accessories

Podium Cover + \$89.60

Heavy Duty Podium Cover + \$128.80

Valet Umbrella + \$285.60

Valet Flap Umbrella + \$336.00

Key Fob Pouch + \$39.20 / pack of 10

Key Fob Pouch - RFID Protection + \$28 / pack of 5



with 200 Key Hooks upgrade

Professional Valet Kiosk

STARTING FROM **\$2968**

The most premium unit offered with the highest key capacity on the market



Basic Features

- Modern, curved appearance with stainless steel accents
- Convex front panel and curved side panels
- Brushed stainless steel transaction counter
- Recessed stainless steel accent on front panel
- Stainless steel kick plate that conceals casters
- 0-400 Key Capacity
- Double wide (47" total width)
- Tip box installed
- Electronics Ready
- Scratch-resistant textured black finish
- Keyhooks w/ white, screen printed numbers
- Corrosion resistant hardware (zinc coated)
- Brushed stainless steel working surface
- Umbrella holder
- 2 Locking, 2 non-locking Heavy-duty casters
- 4 Metal slam-action locks w/ 2 keys
- Tip Slot
- Replaceable parts
- Pre-assembled
- Manufacturer's Warranty

Dimensions: 47"W x 28"D x 51"H

Weight: 350 lbs.

Interior Upgrades

Door Lock

Combination Lock + \$190.40

Schlage Keypad Lock + \$840.00

Key hooks

200 + \$134.40

300 + \$268.80

400 + \$403.20

Miscellaneous

Cash Tray Drawer Insert + \$72.80

Exterior Upgrades

LED Kit (No Battery) + \$179.20

LED Kit + \$487.20

Fold Down Shelf + \$44.80

3 Panel Sneeze guard + \$107.50

Artwork Upgrades

see page 20

Large Magnet + FROM \$285.00

Vinyl Decal + FROM \$350.00

Vinyl Wrap + FROM \$460.00

Accessories

USB Charging Station + \$50.00

Portable Power Station + \$399.00

Podium Cover + \$106.40

Heavy Duty Podium Cover + \$179.20

Valet Umbrella + \$285.60

Valet Flap Umbrella + \$336.00

Key Fob Pouch + \$39.20 / pack of 10

Key Fob Pouch - RFID Protection
+ \$28 / pack of 5

NEW The Boss Valet Kiosk

STARTING FROM **\$3332**

Doublewide | Up to 500 Keys



Basic Features

- Kick plate that conceals casters
- 0-500 Key Capacity
- Double wide (53" total width)
- Tip box installed
- Scratch-resistant textured black finish
- Key hooks w/ white, screen printed numbers
- Corrosion-resistant hardware (zinc-coated)
- Brushed stainless steel working surface
- Umbrella Holder
- 2 Locking, 2 non-locking Heavy-duty casters
- 4 Metal slam-action locks w/ 2 keys
- Tip Slot
- Electronics Ready
- Replaceable parts
- Arrives fully assembled
- Manufacturer's Warranty

Dimensions: 53"W x 28"D x 49.5"H

Weight: 350 lbs

Interior Upgrades

Door Lock

Schlage Keypad Lock + \$840.00

Key hooks

200 + \$263.20

300 + \$526.40

400 + \$789.60

500 + \$1,052.80]

Miscellaneous

Long Shelf + \$72.80

Exterior Upgrades

Curved Counter + \$84.00

LED Kit (No Battery) + \$179.20

LED Kit + \$487.20

3 Panel Sneeze guard + \$120.40

Counter Trim Colors

Stainless

Black

Bronze + \$84.00

Gold + \$84.00

Artwork Upgrades

see page 20

Large Magnet + FROM \$285.00

Vinyl Decal + FROM \$350.00

Vinyl Wrap + FROM \$460.00

Accessories

USB Charging Station + \$50.00

Portable Power Station + \$399.00

Podium Cover + \$106.40

Heavy Duty Podium Cover + \$179.20

Valet Umbrella + \$285.60

Valet Flap Umbrella + \$336.00

Key Fob Pouch + \$39.20 / pack of 10

Key Fob Pouch - RFID Protection
+ \$28 / pack of 5

NEW The Boss 500 Valet Kiosk (White)

STARTING FROM **\$3332**

Doublewide | Up to 500 Keys



Shown above with shelving and key hooks upgrade

Basic Features

- Kick plate that conceals casters
- 0-500 Key Capacity
- Double wide (53" total width)
- Tip box installed
- Scratch-resistant textured white finish
- Key hooks w/ black, screen printed numbers
- Corrosion-resistant hardware (zinc-coated)
- Brushed stainless steel working surface
- Umbrella Holder
- 2 Locking, 2 non-locking Heavy-duty casters
- 4 Metal slam-action locks w/ 2 keys
- Tip Slot
- Electronics Ready
- Replaceable parts
- Arrives fully assembled
- Manufacturer's Warranty

Dimensions: 53"W x 28"D x 49.5"H

Weight: 350 lbs

Interior Upgrades

Door Lock

Schlage Keypad Lock + \$840.00

Key hooks

200 + \$263.20

300 + \$526.40

400 + \$789.60

500 + \$1,052.80]

Miscellaneous

Long Shelf + \$72.80

Exterior Upgrades

Curved Counter + \$84.00

LED Kit (No Battery) + \$179.20

LED Kit + \$487.20

3 Panel Sneeze guard + \$120.40

Counter Trim Colors

Stainless

Black

Bronze + \$84.00

Gold + \$84.00

Artwork Upgrades

see page 20

Large Magnet + FROM \$285.00

Vinyl Decal + FROM \$350.00

Vinyl Wrap + FROM \$460.00

Accessories

USB Charging Station + \$50.00

Portable Power Station + \$399.00

Podium Cover + \$106.40

Heavy Duty Podium Cover + \$179.20

Valet Umbrella + \$285.60

Valet Flap Umbrella + \$336.00

Key Fob Pouch + \$39.20 / pack of 10

Key Fob Pouch - RFID Protection
+ \$28 / pack of 5

CUSTOM PODIUMS

Custom Deluxe Podium



Custom Professional Kiosk



Shown above with optional Laminate Panels & Curved Counters

Sample Customizations



Custom Deluxe Valet Podium

STARTING FROM **\$2408**

Upscale Look | Customizable | Enhanced Security



Basic Features

- All steel construction – 16 gauge, heavy-duty sheet metal
- Counter with brushed stainless steel trim
- Tamper-proof locking security bar (padlock required)
- Locking anchor loop
- Tip box installed
- Electronics compatible with two covered cable inlets
- 50-200 key capacity
- Two-step zinc/ textured powder coat for outstanding weather resistance
- Key hooks w/ white, screen printed numbers
- Zinc hardware
- Brushed stainless steel working surface
- Umbrella holder
- 2 Locking, 2 non-locking Heavy-duty casters
- 2 Metal Slam-action locks with 2 keys
- Tip slot
- Replaceable parts
- Pre-assembled
- Manufacturer's Warranty

Dimensions: 36.5"W x 24"D x 49"H

Weight: 140 lbs.

Interior Upgrades

Door Lock

Combination Lock + \$95.20

Simplex Pushbutton Combination + \$358.40

Schlage Keypad Lock + \$504

Key hooks

100 + \$67.20

150 + \$134.40

200 + \$201.60

Short Shelf + \$33.60

Long Shelf + \$61.60

Exterior Upgrades

Counter Trim Color (Stainless or Black)

Curved Counter + \$56.00

Laminate Panels + \$1,103.20

LED Kit (No Battery) + \$179.20

LED Kit + \$487.20

Artwork Upgrades

Vinyl Print + FROM \$285.00

Acrylic Standoff Sign + \$952.00

LED Sign (No Battery) + \$1,148.00

LED Sign (see p19) + \$1,456.00

Accessories

Podium Cover + \$89.60

Heavy Duty Podium Cover + \$128.80

Valet Umbrella + \$285.60

Valet Flap Umbrella + \$336.00

Key Fob Pouch + \$39.20 / pack of 10

Key Fob Pouch - RFID Protection
+ \$28 / pack of 5

White Custom Deluxe Valet Podium

STARTING FROM **\$2408**

Upscale Look | Customizable | Enhanced Security



Basic Features

- All steel construction – 16 gauge, heavy-duty sheet metal
- Counter with brushed stainless steel trim
- Tamper-proof locking security bar (padlock required)
- Locking anchor loop
- Tip box installed
- Electronics compatible with two covered cable inlets
- 50-200 key capacity
- Two-step zinc/ textured powder coat for outstanding weather resistance
- Key hooks w/ black, screen printed numbers
- Zinc hardware
- Brushed stainless steel working surface
- Umbrella holder
- 2 Locking, 2 non-locking Heavy-duty casters
- 2 Metal slam-action locks with 2 keys
- Tip slot
- Replaceable parts
- Pre-assembled
- Manufacturer's Warranty

Dimensions: 36.5"W x 24"D x 49"H

Weight: 140 lbs.

Interior Upgrades

Door Lock

Combination Lock + \$95.20

Simplex Pushbutton Combination + \$358.40

Schlage Keypad Lock + \$504

Key hooks

100 + \$67.20

150 + \$134.40

200 + \$201.60

Short Shelf + \$33.60

Long Shelf + \$61.60

Exterior Upgrades

Counter Trim Color (Stainless or Black)

Curved Counter + \$56.00

Laminate Panels + \$1,103.20

LED Kit (No Battery) + \$179.20

LED Kit + \$487.20

Artwork Upgrades

Vinyl Print + FROM \$285.00

Acrylic Standoff Sign + \$952.00

LED Sign (No Battery) + \$1,148.00

LED Sign (see p19) + \$1,456.00

Accessories

Podium Cover + \$89.60

Heavy Duty Podium Cover + \$128.80

Valet Umbrella + \$285.60

Valet Flap Umbrella + \$336.00

Key Fob Pouch + \$39.20 / pack of 10

Key Fob Pouch - RFID Protection
+ \$28 / pack of 5

Custom Professional Kiosk

STARTING FROM **\$3920**

Doublewide | Customizable | Up to 500 Keys



Shown above with shelving and key hooks upgrade

Basic Features

- Kick plate that conceals casters
- 0-500 Key Capacity
- Double wide (53" total width)
- Tip box installed
- Scratch-resistant textured black finish
- Key hooks w/ white, screen printed numbers
- Corrosion-resistant hardware (zinc-coated)
- Brushed stainless steel working surface
- Umbrella Holder
- 2 Locking, 2 non-locking Heavy-duty casters
- 4 Metal slam-action locks w/ 2 keys
- Tip Slot
- White acrylic panels
- Electronics Ready
- Replaceable parts
- Arrives fully assembled
- Manufacturer's Warranty

Dimensions: 53"W x 28"D x 49"H

Weight: 350 lbs

Interior Upgrades

Door Lock

Schlage Keypad Lock + \$840.00

Key hooks

200 + \$263.20

300 + \$526.40

400 + \$789.60

500 + \$1,052.80]

Miscellaneous

Long Shelf + \$72.80

Exterior Upgrades

Curved Counter + \$84.00

Laminate Panels + \$840.00

LED Kit (No Battery) + \$179.20

LED Kit + \$487.20

3 Panel Sneeze guard + \$120.40

Counter Trim Colors

Stainless

Black

Bronze + \$84.00

Gold + \$84.00

Artwork Upgrades

Vinyl Print + FROM \$350.00

Acrylic Standoff Sign + \$1,008.00

LED Sign (No Battery) + \$1,204.00

LED Sign (see p19) + \$1,512.00

Accessories

USB Charging Station + \$50.00

Portable Power Station + \$399.00

Podium Cover + \$106.40

Heavy Duty Podium Cover + \$179.20

Valet Umbrella + \$285.60

Valet Flap Umbrella + \$336.00

Key Fob Pouch + \$39.20 / pack of 10

Key Fob Pouch - RFID Protection
+ \$28 / pack of 5

White Custom Professional Kiosk

STARTING FROM **\$3920**

Doublewide | Customizable | Up to 500 Keys



Shown above with shelving and key hooks upgrade

Basic Features

- Kick plate that conceals casters
- 0-500 Key Capacity
- Double wide (53" total width)
- Tip box installed
- Scratch-resistant textured white finish
- Key hooks w/ black, screen printed numbers
- Corrosion-resistant hardware (zinc-coated)
- Brushed stainless steel working surface
- Umbrella Holder
- 2 Locking, 2 non-locking Heavy-duty casters
- 4 Metal slam-action locks w/ 2 keys
- Tip Slot
- White acrylic panels
- Electronics Ready
- Replaceable parts
- Arrives fully assembled
- Manufacturer's Warranty

Dimensions: 53"W x 28"D x 49"H

Weight: 350 lbs

Interior Upgrades

Door Lock

Schlage Keypad Lock + \$840.00

Key hooks

200 + \$263.20

300 + \$526.40

400 + \$789.60

500 + \$1,052.80]

Miscellaneous

Long Shelf + \$72.80

Exterior Upgrades

Curved Counter + \$84.00

Laminate Panels + \$840.00

LED Kit (No Battery) + \$179.20

LED Kit + \$487.20

3 Panel Sneeze guard + \$120.40

Counter Trim Colors

Stainless

Black

Bronze + \$84.00

Gold + \$84.00

Artwork Upgrades

Vinyl Print + FROM \$350.00

Acrylic Standoff Sign + \$1,008.00

LED Sign (No Battery) + \$1,204.00

LED Sign (see p19) + \$1,512.00

Accessories

USB Charging Station + \$50.00

Portable Power Station + \$399.00

Podium Cover + \$106.40

Heavy Duty Podium Cover + \$179.20

Valet Umbrella + \$285.60

Valet Flap Umbrella + \$336.00

Key Fob Pouch + \$39.20 / pack of 10

Key Fob Pouch - RFID Protection
+ \$28 / pack of 5

Custom Podiums in Laminate Panels



Laminate Options



Antique Tobacco
Pine

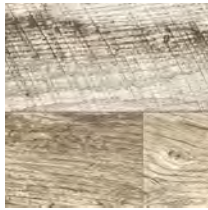

Rediscovered Oak
Planked



Fawn Cypress

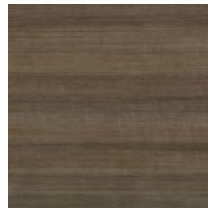

Studio Teak



Skyline Walnut



Continental Walnut

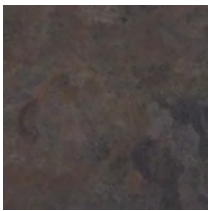

Rustic Slate



Forged Steel



Madagascar



Jubilee Oak

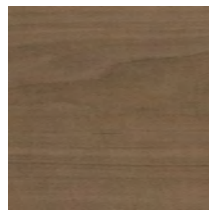

French Pear



Ashbee Oak



White Driftwood



Antique Marula
Pine



Calcutta Marble

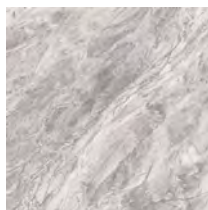

Brazilian Grey

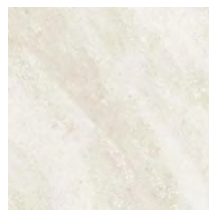

Beachwalk

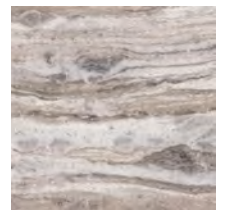

Glacier Quartzite

More laminate options available at [Wilsonart](https://www.wilsonart.com).
Contact us for Pricing, Availability and Delivery Times.

LED Sign for Custom Podiums

Our LED signs are comprised of clear acrylic with three types of design application: Laser-cut laminate, Etched acrylic, and Printed acrylic. The design application will ultimately be determined by the complexity of the logo provided.



Laser-cut laminate

Best for simple designs with thicker linework in one or two colors.



Etched acrylic

Best for more complex logos with fine linework – can be mixed with laser-cut portions to increase visibility and add visual interest.



Printed acrylic

Best for multicolored logos and use with or without LEDs.



The strong, professional look of the custom LED backlit sign is enhanced when the sign is mounted to your Custom Professional Kiosk with 1.5" silver stand-offs. The look is completed with remote-controlled, color-changing LED lighting that creates a "halo" effect on your sign.

The LED kit is powered by a rechargeable cordless battery system with an 8-hour charge cycle. If you need to light up the station for longer than 8 hours, it can be plugged directly into an electrical outlet. The LED kit also comes with a remote operated controller which has multiple speed, brightness, and color settings.

LED Kit includes

- 8 Color options: Red, Orange, Yellow, Blue, Cyan, Purple, White Green
- Waterproof LED strips with multiple color options
- Sealed, 8 hour rechargeable battery w/ power supply
- Easy-to-use controller and remote

Available only on Custom Podiums

Sign sizing: 16"x24"



Don't want it backlit? Ask us for pricing on a sign without LEDs.

PODIUM SIGNAGE

Vinyl Decal



Standard Podium

Front **\$275** | Front & 1 Side **\$355** | Front & Both Sides **\$435**

Compact Podium

Front **\$275** | Front & 1 Side **\$355** | Front & Both Sides **\$435**

Deluxe Podium

Front **\$275** | Front & 1 Side **\$355** | Front & Both Sides **\$435**

Professional Kiosk & The Boss Kiosk

Front **\$350** | Front & 1 Side **\$475** | Front & Both Sides **\$600**

This is a great option for simple logo decals or text without extensive details or backgrounds. The background color will be the color of the podium panel.

*Can be done on all podiums.

Vinyl Wrap



Standard Podium

Front **\$450** | Front & Both Sides **\$690**

Deluxe Podium

Front **\$450** | Front & Both Sides **\$690**

Professional Kiosk & The Boss Kiosk

Front **\$460** | Front & Both Sides **\$845**

This is a great option for larger, more complex designs or designs that require a specific background color other than the color of the podium panel.

PODIUM SIGNAGE

Large Magnet



Standard Podium

Front \$205 | Front & 1 Side \$325 | Front & Both Sides \$445

Compact Podium

Front \$205 | Front & 1 Side \$325 | Front & Both Sides \$445

Deluxe Podium

Front \$205 | Front & 1 Side \$325 | Front & Both Sides \$445

Professional Kiosk & The Boss Kiosk

Front \$285 | Front & 1 Side \$465 | Front & Both Sides \$645

This is a great option for those who want a specific background color but don't want to permanently affect the podium itself.

Our magnets cover the full face of whatever side they are applied to and are fully removable if you decide to use the podium for other uses or companies.

*Not recommended for Custom Deluxe or Custom Professional podiums

Vinyl Print



Custom Deluxe Podium

Front \$285 | Front & Both Sides \$410

Custom Professional Kiosk

Front \$350 | Front & Both Sides \$450

Vinyl print: choice of decal or wrap. Vinyl Decal is a great option for simple logo decals or text without extensive details or backgrounds.

The background color will be the color of the podium panel. Vinyl Wrap is a great option for larger, more complex designs or designs that require a specific background color other than the color of the podium panel. Wrapping will only be done on the panel inserts.

Framing will remain original color.

PODIUM SIZE CHART & LOCK OPTIONS

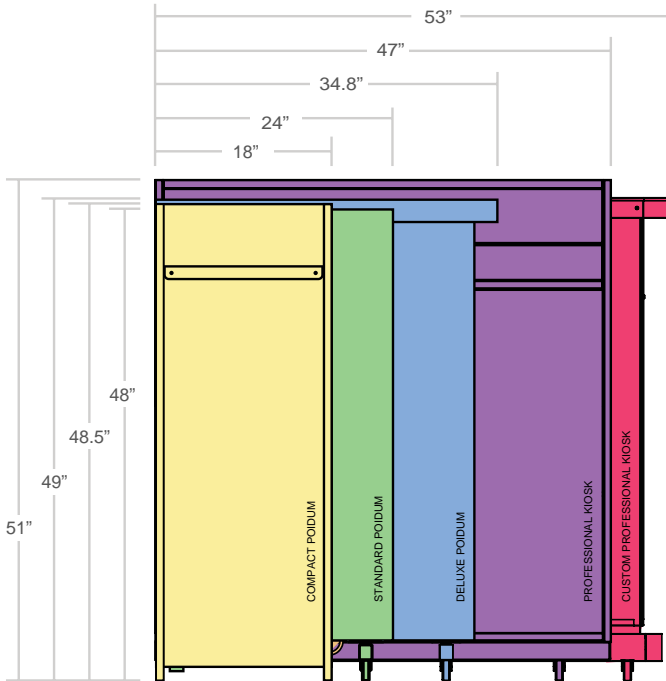

	Slam Lock / Cam Lock	Combination Cam Lock	Simplex Pushbutton	SCHLAGE FE595
Compact Podium	✓	✓		
Standard Podium (Black & White)	✓	✓	✓	✓
Light Box Podium	✓	✓	✓	✓
Deluxe Podium	✓	✓	✓	✓
White Deluxe Podium	✓	✓		✓
Custom Deluxe Podium (Black & White)	✓	✓	✓	✓
Heavy Duty Deluxe Podium				✓
Professional Kiosk	✓	✓		✓
Custom Professional Kiosk (Black & White)	✓			✓
The Boss Valet Kiosk (Black & White)	✓			✓



Slam Lock

Standard lock with key. Locks automatically when door is closed. Reliable, fast and secure.



Simplex Pushbutton Combination Lock

Keyless entry. Push in the combination to access. Locks automatically when door is closed. Fast keyless entry, resettable combination, no keys to manage.



Combination Cam Lock

Access with the master key or dial in the 4 digit combination. Must be manually locked and does not have the ability to be "slam locked". Resettable combination w/ master key helps with keeping track of multiple keys.



SCHLAGE FE595 Keypad Entry

Convenient and secure keyless access which locks automatically when door is shut. Program up to 19 user codes to fit your security needs. Battery operated keypad lights up for visibility at night. 3 year battery life.



Key Cam Lock

Cam lock needs to be manually locked. Option for keyed alike and keyed different.

SNEEZE GUARDS

Add a sneeze guard to your purchase of the podiums listed below. Or buy a countertop shield and retrofit it to a podium you already have.

Protect employees and customers with acrylic countertop shields from The Valet Spot. These social distancing barriers – also called sneeze guards – add .22” of protection from harmful airborne particles. Countertop shields are especially important as businesses begin to reopen after Covid-19 closures. Our new sneeze guards extend each podium to a total height of 6’ and are up to 28” wide depending on the model.

The Valet Spot sneeze guards come ready to use with pre-installed magnets

3 Panel Sneeze Guards



- Compact Podium **\$75.00**
- Standard Podium **\$75.00**
- Light Box Podium **\$75.00**
- Deluxe Podium **\$95.00**
- Heavy Duty Deluxe Podium **\$89.60**
- Custom Professional Kiosk **\$120.40**
- Professional Kiosk **\$107.50**
- The Boss Kiosk **\$120.40**



KEY BOXES & BOARDS

24 Key Portable Box

STARTING FROM **\$218.40**



- 24 key hook capacity
- 16 gauge zinc treated steel
- Textured powder coat finish
- Pre-drilled mounting holes
- Staggered key hooks w/ white, screen printed numbers
- Stainless steel hardware
- 1 Metal slam-action lock
- Manufacturer's Warranty

Dimensions: 18" W x 6" D x 21.5" H
Weight: 20 lbs.

Door Lock Option

Key Cam Lock

Combination Lock + **\$95.20**

Add On

Key Fob Pouch (Pack of 10) + **\$39.20**

50 Key Portable Box

STARTING FROM **\$319.20**



- 50 key hook capacity
- 16 gauge zinc treated steel
- Textured powder coating
- Pre-drilled mounting holes
- Staggered key hooks w/ white, screen printed numbers
- Folding handle
- Stainless steel hardware
- 1 Metal slam-action lock
- Manufacturer's Warranty

Dimensions: 21.5" W x 4" D x 27" H
Weight: 25 lbs.

Door Lock Option

Key Cam Lock

Combination Lock + **\$95.20**

Add On

Key Fob Pouch (Pack of 10) + **\$39.20**

KEY BOXES & BOARDS



100 Key Box

STARTING FROM **\$492.80**



- 100 Key hook capacity
- 1 Metal slam-action lock
- Staggered key hooks w/ white, screen printed numbers
- Pre-Drilled Mounting Holes
- Zinc pre-coating
- Textured powder coat finish
- Manufacturer's Warranty

Dimensions: 23.25" W x 5" D x 29.5" H
Weight: 40 lbs.

Door Lock Option

Key Cam Lock

Combination Lock + **\$95.20**

Add On

Key Fob Pouch (Pack of 10) + **\$39.20**



100 Keybox with Keypad

\$800.80



- 100 Key hook capacity
- Two Step Zinc/Textured Powder Coat
- Pre-Drilled Mounting Holes
- Keypad Lock
- Staggered key hooks w/ white, screen printed numbers

Dimensions: 23.5" W x 9" D x 29.5" H
Weight: 52 lbs.

Add On

Key Fob Pouch (Pack of 10) + **\$39.20**

KEY BOXES & BOARDS

200 Key Box with Keypad

\$1,064



- 200 Key Capacity
- Two Step Zinc/Textured Powder Coat
- Pre-Drilled Mounting Holes
- Keypad Lock
- Staggered key hooks w/ white, screen printed numbers
- Manufacturer's Warranty

Dimensions: 23" W x 11" D x 29"

Weight: 80 lbs.

Add On

Key Fob Pouch (Pack of 10) + \$39.20



50 Key Box with Stand

STARTING FROM \$649.60



- Two large wheels
- Small, lightweight folding design
- Umbrella holder
- 50 Key hook capacity
- 1 Metal slam-action lock
- Staggered key hooks w/ white, screen printed numbers
- Zinc pre-coating
- Textured powder coat finish
- Folding handle
- Manufacturer's Warranty

Dimensions: 24" W x 21" D x 51" H

Weight: 62 lbs.

Door Lock Option

Combination Lock + \$95.20

Add On

Key Fob Pouch (Pack of 10) + \$39.20

KEY BOXES & BOARDS



100 Key Box with Stand

STARTING FROM **\$1,052.80**

- 100 Key hook capacity
- 1 Metal slam-action lock
- Staggered key hooks w/ white, screen printed numbers
- Zinc pre-coating
- Textured powder coat finish
- Adjustable height
- Manufacturer's Warranty

Dimensions: 23.5" W x 9" D x 75" H

Weight: 151 lbs.

Door Lock Option

Combination Lock + \$95.20

Add Ons

Key Fob Pouch + \$39.20 / pack of 10

Umbrella Holder + \$50.40

Valet Umbrella + \$285.60

Valet Flap Umbrella + \$336.00



100 Key Box (X2) with Stand

STARTING FROM **\$1,545.60**

- 200 Key Capacity
- Zinc Pre-coating
- Pre-Drilled Mounting Holes
- 2 Slam-action Locks
- Staggered key hooks w/ white, screen printed numbers
- Manufacturer's Warranty

Dimensions: 28" W x 26" D x 75" H

Weight: 200 lbs.

Door Lock Option

Combination Lock + \$95.20 / key box

Add Ons

Key Fob Pouch + \$39.20 / pack of 10

Umbrella Holder + \$50.40

Valet Umbrella + \$285.60

Valet Flap Umbrella + \$336.00

* Each box can only have 1 - 100 numbered key hooks.

KEY BOXES & BOARDS



100 Keybox with Keypad & Stand

STARTING FROM \$1,360.80

- 100 Key Capacity
- Two Step Zinc/Textured Powder Coat
- Pre-Drilled Mounting Holes
- Keypad Lock
- Staggered key hooks w/ white, screen printed numbers
- Adjustable height

Dimensions: 28" W x 26" D x 75" H

Weight: 151 lbs.

Add Ons

Key Fob Pouch + \$39.20 / pack of 10

Umbrella Holder + \$50.40

Valet Umbrella + \$285.60

Valet Flap Umbrella + \$336.00



100 Keybox with Keypad (X2) & Stand

STARTING FROM \$2,161.60

- 100 Key Capacity
- Two Step Zinc/Textured Powder Coat
- Pre-Drilled Mounting Holes
- Keypad Lock
- Staggered key hooks w/ white, screen printed numbers
- Adjustable height

Dimensions: 28" W x 26" D x 75" H

Weight: 203 lbs.

Add Ons

Key Fob Pouch + \$39.20 / pack of 10

Umbrella Holder + \$50.40

Valet Umbrella + \$285.60

Valet Flap Umbrella + \$336.00

* Each box can only have 1 - 100 numbered key hooks.

KEY BOXES & BOARDS



200 Key Box with Keypad & Stand

STARTING FROM **\$1,624**

- 200 Key Capacity
- Keypad Lock
- Two Step Zinc/Textured Powder Coat
- Pre-Drilled Mounting Holes
- Keypad Lock
- Staggered key hooks w/ white, screen printed numbers

Add Ons

- Key Fob Pouch + **\$39.20 / pack of 10**
- Umbrella Holder + **\$50.40**
- Valet Umbrella + **\$285.60**
- Valet Flap Umbrella + **\$336.00**

Dimensions: 28" W x 26" D x 75" H

Weight: 208 lbs.



200 Key Box with Keypad (X2) & Stand

STARTING FROM **\$2,688**

- 200 Key Capacity
- Keypad Lock
- Two Step Zinc/Textured Powder Coat
- Pre-Drilled Mounting Holes
- Keypad Lock
- Staggered key hooks w/ white, screen printed numbers

Add Ons

- Key Fob Pouch + **\$39.20 / pack of 10**
- Umbrella Holder + **\$50.40**
- Valet Umbrella + **\$285.60**
- Valet Flap Umbrella + **\$336.00**

Dimensions: 28" W x 26" D x 75" H

Weight: 288 lbs.

* Each box can only have 1-200 numbered key hooks.

KEY BOXES & BOARDS



50 Wood Key Board w/ Frame

\$162.40



- 50 key capacity
- High quality wood laminate
- Pre-Drilled Mounting Holes
- Staggered key hooks w/ white, screen printed numbers
- Available in Black & Asian Night finish
- Metal frame with black finish
- Manufacturer's Warranty

Dimensions:

23.5" W x 1.25" D x 25.5" H

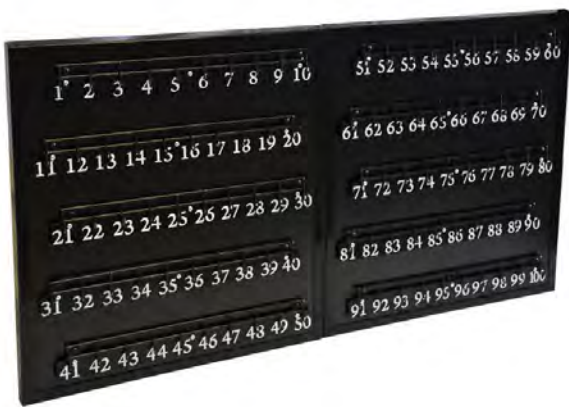

100 Wood Key Board w/ Frame

\$274.40



- (2) Key boards with 100 key hooks
- High quality wood laminate
- Pre-Drilled Mounting Holes
- Staggered key hooks w/ white, screen printed numbers
- Metal frame with black finish
- Available in Black & Asian Night finish
- Manufacturer's Warranty

Dimensions:

47" W x 1.25" D x 25.25" H

Key Box Stand \$330.40

for use with the 50 Key Box



- Two large wheels
- Small, lightweight folding design
- Umbrella holder
- Zinc pre-coating
- Textured powder coat finish
- Manufacturer's Warranty

Dimensions: 24" W x 16.5" D x 26" H
Weight: 30 lbs.

Key Box Stand \$560

for use with up to two 100 Key Boxes



- Zinc pre-coating
- Textured powder coat finish
- Adjustable height
- Manufacturer's Warranty

Dimensions: 28" W x 26" D x 75" H

DELINEATOR SIGNS

Our Delineator Signs are made of durable, black/white plastic panels with a 20 lb. rubber base. The graphics are printed on to reflective vinyl for better visibility.



Sign Style "Left Arrow"

Single Sided Print **\$155.00**

LED Light (Solar Powered) + **\$35**



Sign Style "Right Arrow"

Single Sided Print **\$155.00**

LED Light (Solar Powered) + **\$35**



Sign Style "Left / Right Arrow"

Double Sided Print **\$185.00**

LED Light (Solar Powered) + **\$35**



Sign Style "Lot Full"

Single Sided Print **\$155.00**

Double Sided Print **\$185.00**

LED Light (Solar Powered) + **\$35**



Sign Style "Pull Forward"

Single Sided Print **\$155.00**

Double Sided Print **\$185.00**

LED Light (Solar Powered) + **\$35**



Sign Style "Stop Sign"

Single Sided Print **\$155.00**

Double Sided Print **\$185.00**

LED Light (Solar Powered) + **\$35**

DELINEATOR SIGNS



Sign Style "Valet"

Single Sided Print **\$155.00**
 Double Sided Print **\$185.00**

LED Light (Solar Powered) + **\$35**



Custom Delineator Sign

Single Sided **\$155.00**
 Double Sided **\$185.00**

Artwork Setup (Optional) + **\$50**
 LED Light (Solar Powered) + **\$35**



Delineator Sign Base

Single **\$105.00**
 3-pack **\$307.00** Save \$14.97
 6-pack **\$600.00** Save \$28.94
 12-pack **\$1170.00** Save \$80.88

LED Light (Solar Powered) + **\$35**



LED Light on Delineator Sign Base

Stand out the perfect amount with a combination of custom signage that's unified and stylish.



Deluxe Valet Podium with Magnet Signage, Custom Delineator Sign

VALET UMBRELLAS

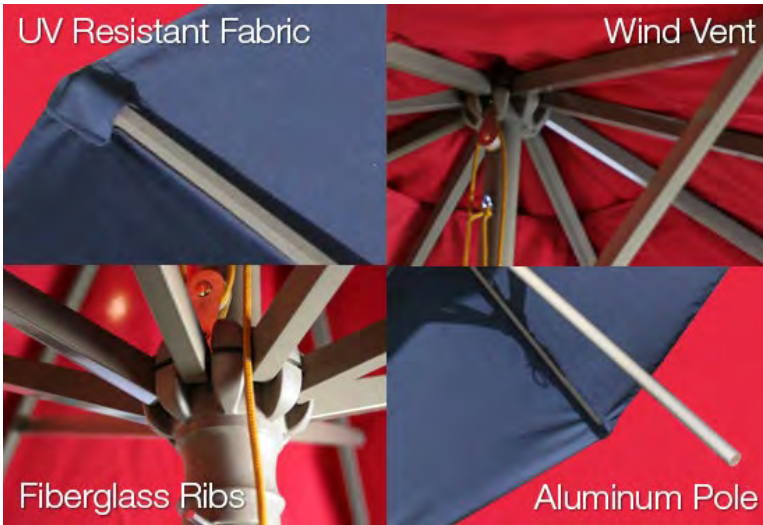

Valet Umbrella

- 7.5' umbrella
- Aluminum pole and fiberglass ribs for maximum durability
- Manual pulley system for easy opening
- Vibrant polyester canvas
- 1.5" Pole diameter
- 2-year fade protection on the canvas

Our valet umbrellas are a great way to add a little class to your valet operation and help draw the attention of your customers. Each umbrella features an aluminum pole and fiberglass ribs which are more durable than traditional wood valet umbrellas.

Although durable, our umbrellas are not designed to withstand strong winds. To prevent damage to the umbrella and to the podium, umbrellas should always be taken down when the wind picks up.



Black, Dark Blue & Maroon **\$285.60**

2-year fade protection on the canvas

VALET UMBRELLAS



Valet Flap Umbrella

\$336

- 7.5' umbrella with flaps (every other features white valet lettering)
- Aluminum pole and fiberglass ribs for maximum durability
- Manual pulley system for easy opening
- Vibrant polyester canvas
- 1.5" Pole diameter
- 2-year fade protection on the canvas

AVAILABLE IN



Black Umbrella – With Flap, No Printing \$319.20



*PODIUM NOT INCLUDED

LIGHTS

Light up your valet podium at night and draw attention to your valet operation. Make your valet attendant's job easier by lighting up the working area at night.

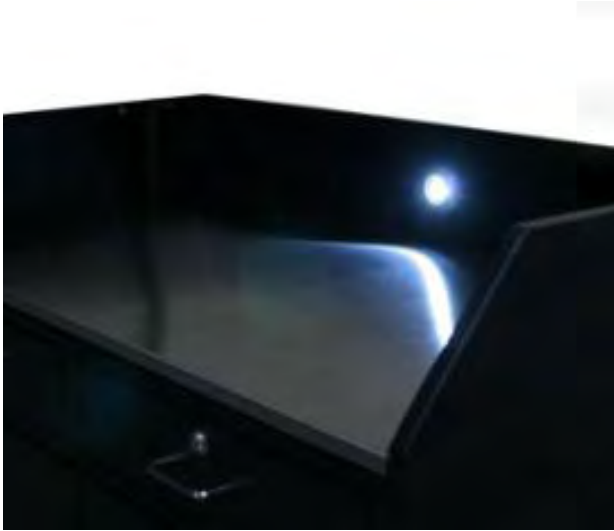

Tap Lights

\$40.00

- 2 Power Supply wireless umbrella lights
- 5 LEDs per Tap Light to cast a bright light
- Includes double-sided tape for easy installation
- One touch activation
- Three settings on/dim/ off
- Sold in packs of three



LED Light (Solar-Powered)

\$35.00

- 310 upgraded high power LEDs
- 270° wide lighting angle, illumination coverage to light up 1000 square ft.
- PIR motion inductor provides motion sensitivity up to 26 feet within 120° detect angle.
- 2400 mAh rechargeable lithium-ion battery
- PET laminated solar panel, 3.8W Monocrystalline silicon with up to 23% Conversion Rate.
- High-strength ABS material and waterproof design, reaching IP65 waterproof level.
- 3 Optional Lighting Modes
 - Constant on mode(Keep medium light all night)
 - Dim light sensor mode(Turn to high light when motion detected, turn to dim light after people leave)
 - High light sensor mode(Turn to high light when motion detected,turn off after people leave)

PODIUM COVERS

Professional Kiosk Cover \$106.40

For use with our Professional Kiosks and The Boss Kiosks

- Weather-resistant
- 2-ply construction
- Locking eyelets
- Umbrella Pouch



Standard Podium Cover \$89.60

For use with our Standard, or Compact Podiums

- Weather-resistant
- 2-ply construction
- Locking eyelets
- Umbrella Pouch



Deluxe Podium Cover \$89.60

For use with our Deluxe Valet Podiums

- Weather-resistant
- 2-ply construction
- Locking eyelets
- Umbrella Pouch



Heavy Duty Podium Covers

Standard/Compact/Deluxe Podiums \$128.80

Professional Kiosks/The Boss Kiosks \$179.20



OTHER EQUIPMENT



Portable Power Station BLUETTI AC50B – 700W 448Wh

\$399.00

Portable | Durable | Lightweight

- 448Wh capacity for extended battery life ;
- 700W continuous power, 1,000W lifting power ;
- Smart Turbo Charging: 0-80% capacity in just 45 minutes ;
- Built to Last: Ultra-safe LiFePO4 battery with 3,000+ life cycles ;
- Solar-Ready: Pass-through charging, harness solar energy efficiently ;
- 6 Ways to Recharge: Flexible to get charged via AC, solar, car, generator, B80 battery, or dual AC + solar ;
- Smart Control: Monitor and manage via the BLUETTI App ;
- Peace of Mind: Backed by an industry-leading 5-year warranty.

MISCELLANEOUS



Key Fob Pouch
\$39.20(pack of 10)



**Key Fob Pouch –
RFID Protection**
\$28.00 (pack of 5)



Keycard Carry Pouch
\$5.04

MISCELLANEOUS



Magnetic Contract Sign with Reflective Vinyl

\$35.00

Dimensions: 12" W x 18" H



Custom Decal Print for Delineator Signs

\$50.00



Decal Print (Black) for Delineator Sign

\$50.00



Decal Print (White) for Delineator Sign

\$50.00

MISCELLANEOUS



Cash Tray Drawer Insert

\$72.80

Dimensions: 12"W x 10"D x 2"H



Heavy Duty, Lockable Tip Box

\$67.20

- Large tip slot for inserting cash, checks, tickets, etc.
- Easily mountable to wall or in any of our valet podiums
- Black textured powder coating
- Each box is keyed differently
- Heavy duty construction

Dimension: 4.5" x 4" x 11"



Large, Heavy Duty, Lockable Tip Box

\$78.40

- Large tip slot for inserting cash, checks, tickets, etc.
- Easily mountable to wall or in any of our valet podiums
- Black textured powder coating
- Each box is keyed differently
- Heavy duty construction

Dimension: 7.5" x 4" x 11"

REPLACEMENT PARTS

Replace parts, not podiums. We believe that makes more sense.



Heavy Duty Casters
(4 pack) \$89.60
(2 pack) \$50.40



Drawer Tracks
(Sets of 2, fixes one drawer)
\$22.40

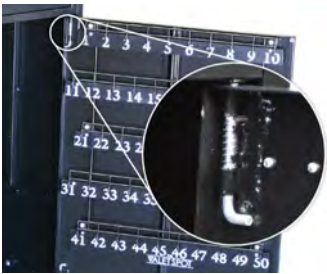

Spring Latch for Door
\$3.00



Door/Drawer Handles
(2 Pack) \$19.04

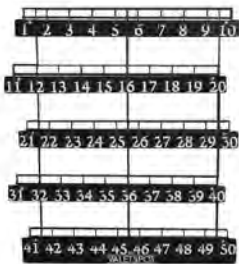

Keyhooks (1-50, 51-100, 101-150, 151-200)
\$67.20



Key Box Stand (for use with the 50 Key Box)
\$330.40



Key Box Stand (for 100 or 200 Key boxes)
\$560.00

REPLACEMENT PARTS



**New Remote +
Controller**
\$71.50



**Replacement
Battery**
\$302.50



**Metal Slam-Action
Replacement Keys**
\$13.44



**Key Cam Lock
Replacement Keys
(Compact Podium Only)**
\$14.56



**Combination Lock
Replacement Keys**
\$10.64



**Key Cam Lock
(Compact Podium Only)**
\$23.52



**Metal Slam-Action
Key Lock**
\$20.72



**Tip Box Lock
Replacement**
\$14.00

REPLACEMENT PARTS



Combination Lock
\$95.20



**Simplex Pushbutton
Combination Lock**
\$229.60



**Deluxe + Schlage
Upgrade**
\$504.00



**Schlage Upgrade Kit
for Professional Kiosk**
\$840.00



**Deluxe + Simplex
Upgrade**
\$358.40



**Standard + Simplex
Upgrade**
\$358.40



Umbrella Holder
(For All Podiums)
\$13.44



Umbrella Holder
(For Key Box Stand)
\$50.40

REPLACEMENT PARTS



Umbrella Canvas \$84.00



**Umbrella Canvas Flap with Printing
\$106.40**

C-clip, L latch, and spring (hinge packet) can also be replaced.
Please call us to find out more.



**Reliable equipment.
100% Guaranteed.**

The Valet Spot will replace any broken part or product resulting from a defect in workmanship within the first three years.

It is our mission at The Valet Spot to constantly seek out new ways to provide value for you, our customer.

When we asked ourselves how we could do a better job of that, we realized that nothing would go further than offering you a manufacturer's guarantee on all of our products.

It ensures we're holding ourselves to the highest standards throughout the design and manufacturing process.

More importantly, it gives you the peace of mind that you're buying products of superior quality, design and craftsmanship.

The Valet Spot will replace any broken part or product resulting from a defect in workmanship within the first three years.

[Read the Full Details of our Manufacturer's Warranty here.](#)

PORTFOLIO

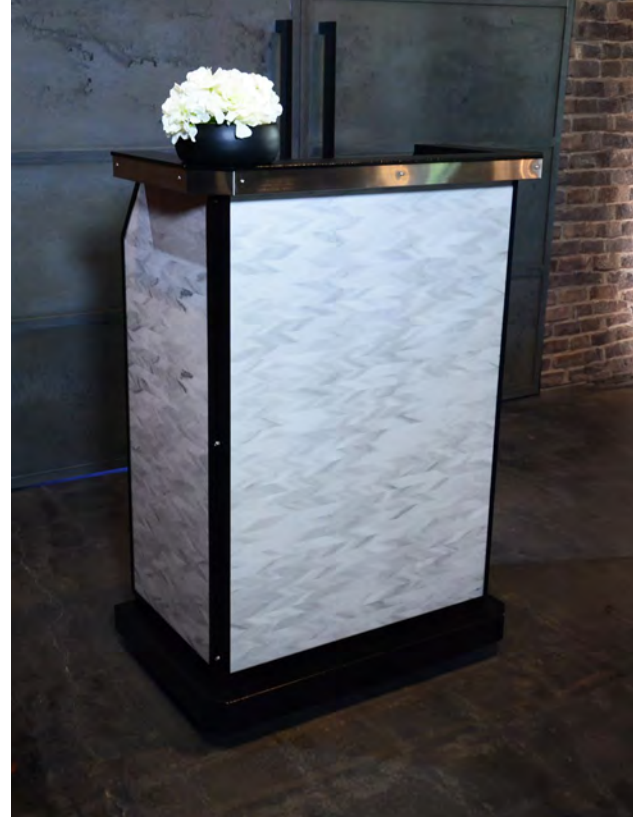

PORTFOLIO



PORTFOLIO



PORTFOLIO



PORTFOLIO



PORTFOLIO

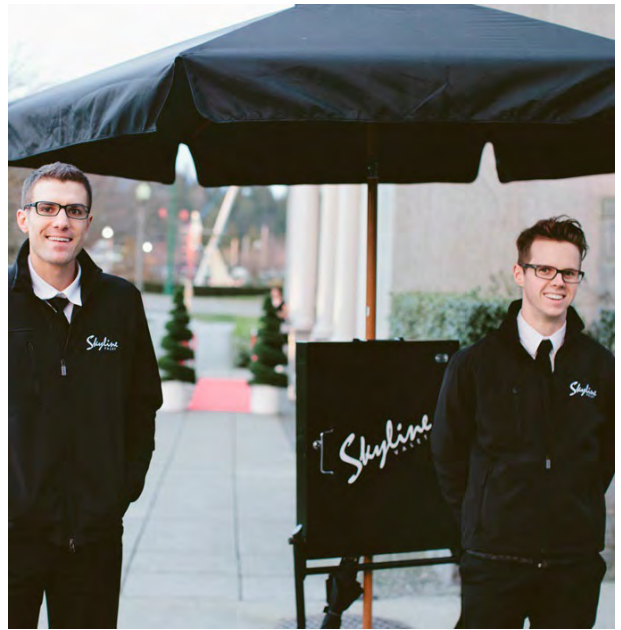

PORTFOLIO



PORTFOLIO



TESTIMONIALS

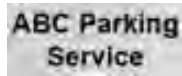

"[The Classic Podium] is awesome! The quality of your materials is fantastic!" – John, ABC Parking



"[The Standard Podium] is great...it is hands down the best podium we have ever had." - Joel, Executive Parking



"Hope all is good in CA, we love the key stand... your products are the best I have come across." - Ryan B., Tri-State Valet and Parking Service



"Versatility and affordability is why the Valet Spot's portable podium is such a strong value for us." - Chuck, Chattanooga Valet



"The podium is solid...we roll it in and out every day. It looks great and it's held up well." - Scott, Lincoln San Diego



" [The Standard Podiums] are fantastic... They are great quality and serve exactly what we needed them for" - Michael Venuto, US Airways



"We have received the Designer Series Podium and are happy with the results! Thank you again for your help." - Jessie, MountainGate Country Club



"We got the kiosk and it is fantastic! The size is exactly what we were looking for and it fits in with the aesthetics of our lounge. Thank you for another great piece!" - Mike, Willows Lodge



"Simply the best made podiums, key boxes and superior customer service." - Jeremy S., ProPark

TESTIMONIALS



*"We received the kiosk this morning. I wanted to let you know that the **shipment was in great condition and it was well packed for the long trip**, we were very pleased." - Bryann B., UPMC Mercy Hospital*



*"The (Deluxe) podium is perfect! Thanks for the **quick processing and shipping!**" - Cameron, Director of Valet, USA Parking System*



"...We love the podium." - Ellis D., Advanced Parking Concepts



"The podium looks great!" - Miguel, Hotel Monteleone



"The (Portable Podiums) are perfect for what we do. I've been hoping someone would come out with this product...they are just what we needed." - John C., CDC Parking Mgmt.



"The Professional Podium is wonderful...It's exactly what we were looking for." – Russel, The Hilton Indianapolis



"We got the kiosk and it is fantastic! The size is exactly what we were looking for and it fits in with the aesthetics of our lounge. Thank you for another great piece!" - Mike, Willows Lodge



"Love the portability of it...where as I would normally have to transport (podiums) in a truck, I can now easily fit in the back seat of a small two door car. It is a great product for companies that need to be able to relocate podiums often." - Josh W., Valet Solutions



"Hope all is well. The portable valet podium is a big hit with our attendants, looking forward to ordering more!" - Mark, Las Vegas Parking

Our Values

Premium Quality Products

Unrivalled Value

Long-lasting Durability

Premium Custom Podiums and Kiosks

Superior Customer Service

2026 HOLIDAY SERVICE SCHEDULE

The Valet Spot will be closed on these dates.

Thursday	January 01	New Year's Day
Monday	January 19	Martin Luther King Jr. Day
Monday	May 25	Memorial Day
Friday	June 19	Juneteenth
Saturday	July 04	Independence Day
Monday	September 07	Labor Day
Monday	October 12	Columbus Day
Wednesday	November 11	Veterans Day
Thu-Fri	Nov 26 - 27	Thanksgiving
Friday	December 25	Christmas Day
Thu-Fri	Dec 24 - Jan 1	The Valet Spot (Closed for the Holidays)

THANK YOU FOR VIEWING OUR CATALOG.

Call Us at (877) 977-8733

Email Us at sales@thevaletspot.com
for more information or a quote

View the latest copy of the catalog at
<https://www.thevaletspot.com/catalog/>

THE VALET SPOT™

San Diego, CA

www.thevaletspot.com

Updated: December 2025